

Bereich: 76,511m²

Kuflertweg
Kuflertweg
Kuflertweg

gesamt 1307m² *

- 16.) 64m² -40% = 256m²
- 6.) 1218m² -40% = 48,72m²
- 7.) 60,4m² -80% = 48m²
- 8.) 196m² -40% = 78,4m²
- 9.) 49m² -40% = 19,6m²
- 10.) 80m² -25% = 20m²
- 11.) 300m² -80% = 240m²
- 12.) 1000m² -60% = 600m²
- 13.) 77m² -100% = 77m²
- 14.) 130m² -50% = 65m²
- 15.) 36m² -40% = 44,4m²

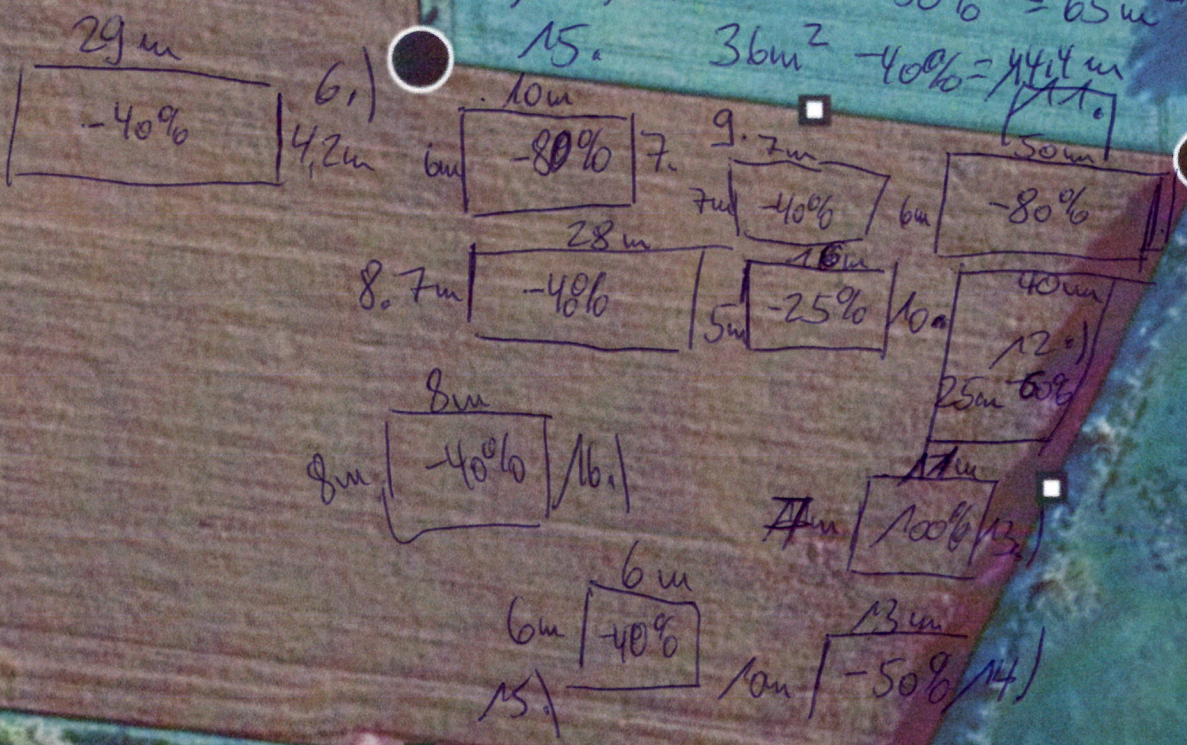

Bereich: 76,511m²



Kurlertweg

Kurlertweg

Kurlertweg

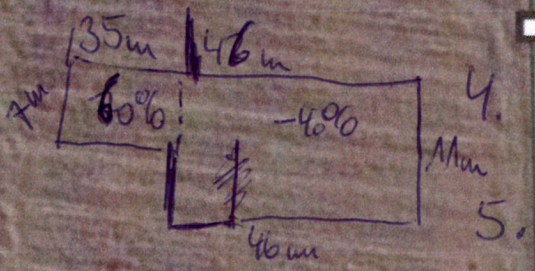
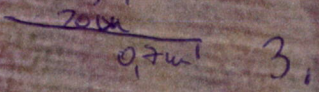
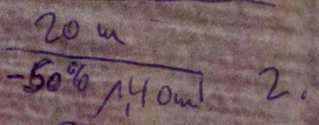
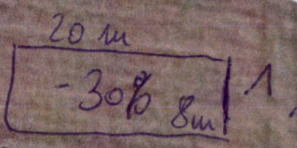

1. $160 \text{ m}^2 - 30\% = \overset{48}{\cancel{112}} \text{ m}^2$

2. $28 \text{ m}^2 - 50\% = 14 \text{ m}^2$

3. $u \quad u = 14 \text{ m}^2$

4. $506 \text{ m}^2 - 40\% = \overset{202,4}{\cancel{307}} \text{ m}^2$

5. $245 \text{ m}^2 - 40\% = \overset{98}{\cancel{147}} \text{ m}^2$

~~537 m²~~
376,4 m²
+ 130,7
1685,4 m²

Bereich: 51,980m²

€
0,017

1) $30m^2 - 40\% = 18m^2$

2) $36m^2 = 10,8m^2$

3) $100m^2 = 30m^2$

4) $300m^2 = 150m^2$

5) $216m^2 = 126m^2$

4778m²

+ 1683,4m²

= 2156,2m²

x 0,20€

431,24€

gesamt

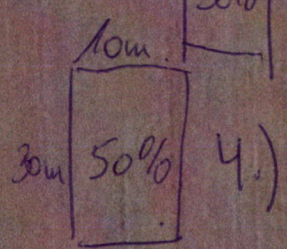
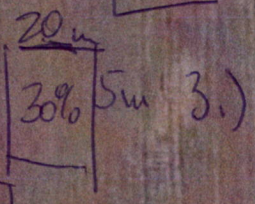
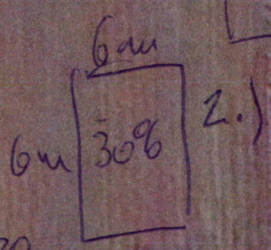
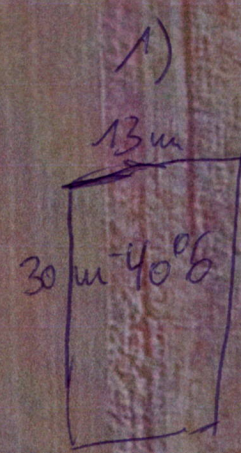
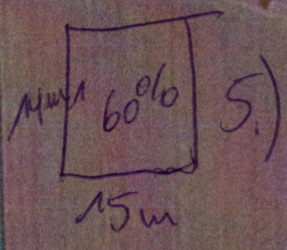

gle